



# ALUMAX

## BATH ENCLOSURES

a product of Alcoa

Tel: 800-643-1514  
 Fax: 870-234-3181  
 www.alumaxbath.com

### PARTS LIST

- A. 1 7/8" Dia. Cast Acrylic Towel Bar
- B. 2 1 3/8" Dia. Towel Bar Cap
- C. 4 1 1/8" Rubber Towel Bar Gasket
- D. 2 3/8" x 3/16" Long Nylon Towel Bar Bushing  
 2 3/8" x 3/8" Long Nylon Towel Bar Bushing
- E. 2 1 1/4" Dia. Threaded Towel Bar Base
- F. 2 #8 x 7/16" Flat Head Screw  
 2 #8 x 5/8" Flat Head Screw
- G. 2 Retaining Ring
- H. 2 1 1/8" Inner Towel Bar Ring
- J. 2 1 1/2" Outer Towel Bar Ring

*T-bar bushings and assembly screws are supplied in two different lengths to fit .188"/.250" or .375" thick glass door panels.*

**PULL KNOB WITH BUMPER MUST BE PURCHASED SEPARATELY.**

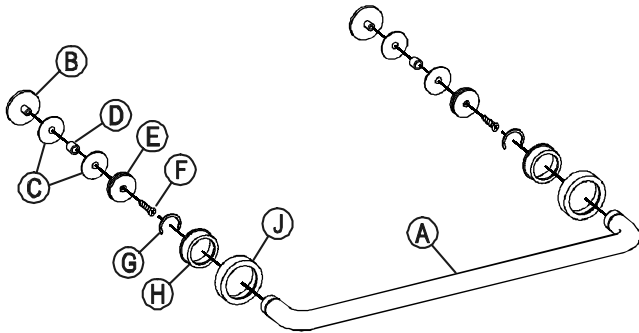

## DELUXE TOWEL BAR

### INSTALLATION INSTRUCTIONS

**1**

Place one outer towel bar ring [J] and one inner towel bar ring [H] over on end of the Acrylic Bar [A]. Slide the rings past the groove in the bar and snap a retaining ring [G] into the groove. Repeat for the other end of the bar.

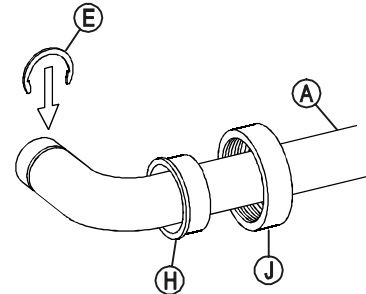

**2**

Place a nylon handle bushing [D] (length determined by the glass thickness) over the shank of a towel bar cap [B]. Slip a rubber washer [C] over the bushing. Insert the cap and bushing into a 1/2" hole in one of the doors. Place a second rubber washer against the opposite surface of the glass, position the threaded towel bar base [E] over it and attach it securely with a #8 flat head screw [F]. Repeat for the other end of the bar.

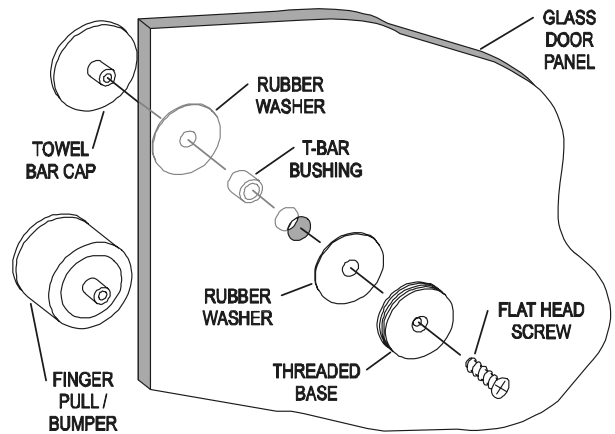

**3**

Hold the acrylic towel bar assembly against the threaded handle bases and screw the outer handle rings onto the bases. Do not overtighten or use tools that might damage the finish.

